

**Model UCL-STF100 100 Watts DC-3GHz**

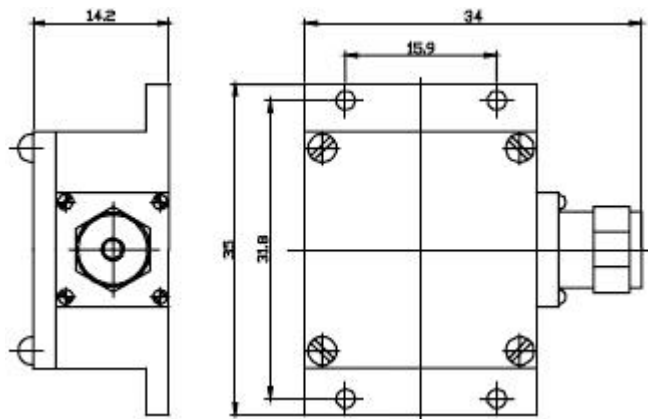

Inset terminations are used in quantitatively absorbing energy of RF and microwave system, they are commonly used as dummy loads of antenna and transmitter.

UCL-STF inset termination's average power 30W, frequency range from 7.5-8.5GHz and the features include wide frequency band, low VSWR, excellent capacity in anti-pulse and anti-burnout etc.

## MECHANICAL SPECIFICATIONS

|            |                              |
|------------|------------------------------|
| Connectors | Brass Nickel Plated          |
| Male Pin   | Brass Gold Plated            |
| Female Pin | Beryllium Copper Gold Plated |
| Housing    | Aluminum                     |
| Temp Range | -55°C~+125°C                 |
| Dimensions | 34×35×14.2mm                 |
| Weight     | 26g                          |

**RoHS Compliant: Yes**

## ELECTRICAL SPECIFICATIONS

| Model Number | Frequency Range (GHz) | Max VSWR |
|--------------|-----------------------|----------|
| UCL-STF100-3 | DC-3                  | 1.25     |

**NOMINAL IMPEDANCE:** 50Ω

**AVERAGE POWER:** 100W average to 25°C ambient temperature, derated linearly to 10W @ 125°C.

**PEAK POWER:** 1KW (5μs pulse width with 10% duty cycle)

**CONNECTOR TYPE:** SMA(M)

### Notes:

1. Dimensions Tolerance  $\pm 2\%$
2. Dimensions and specifications refer to connector type N unless otherwise specified.
3. Custom designs available.