



UNIVERSAL COOPERATE LTD.



Model UCL-STF30
Inset Termination
30 Watts 7.5-8.5GHz

Inset terminations are used in quantitatively absorbing energy of RF and microwave system, they are commonly used as dummy loads of antenna and transmitter.

UCL-STF30 inset termination's average power 30W, frequency range from 7.5-8.5GHz and the features include wide frequency band, low VSWR, excellent capacity in anti-pulse and anti-burnout etc.

NOMINAL IMPEDANCE: 50Ω
AVERAGE POWER: 30W average to 25°C ambient temperature, derated linearly to 3W @ 125°C.
PEAK POWER: 1KW (5μs pulse width with 3% duty cycle)
TEMPERATURE RANGE: -55°C~+125°C
CONNECTOR TYPE: N,SMA
WEIGHT: 25g
PHYSICAL DIMENSIONS: 38×28×27mm

Model Number	Frequency Range(GHz)	Max VSWR
UCL-STF30	7.5-8.5	1.30

Outline Drawings

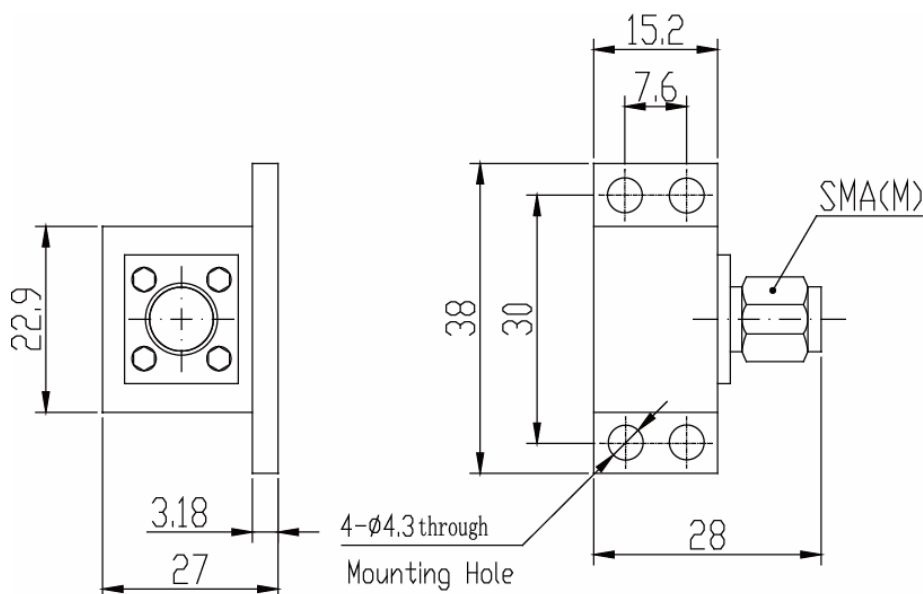

* Dimensions are given in mm and tolerance $\pm 2\%$.

** VSWR varies according to frequency.

*** VSWR and dimensions refer to connector type N.